

Commercial Synthetic Chemistry Facility, 710 Parkside Avenue, Brooklyn, NY 11226 - approximately 13,000 square feet

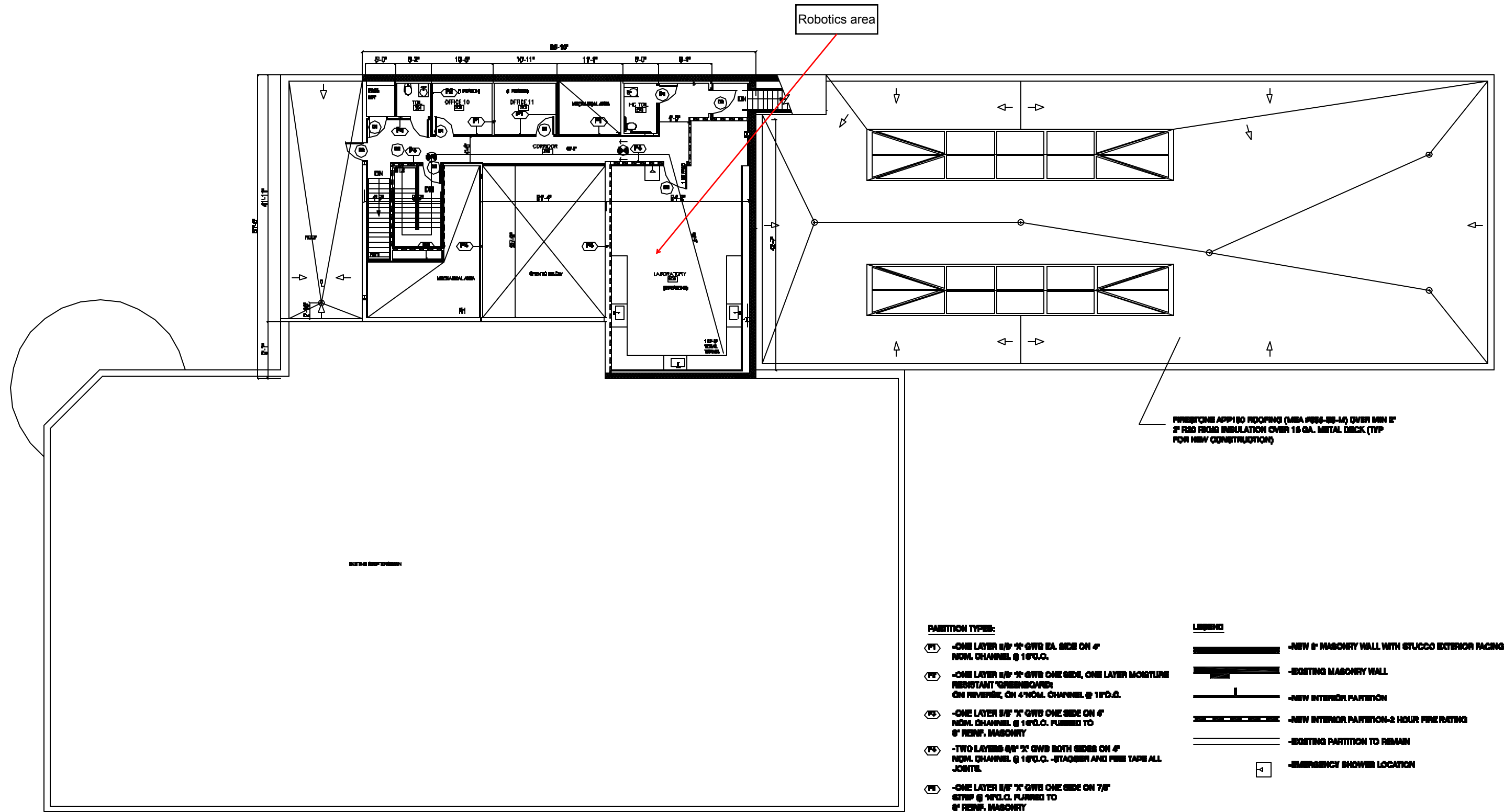

PARTITION TYPES:

- PT - ONE LAYER 1/2" X 4" GWB EA. SIDE ON 4" NOML. CHANNEL @ 16" O.C.
- PF - ONE LAYER 1/2" X 4" GWB ONE SIDE, ONE LAYER MOISTURE RESISTANT GYPSUMBOARD ON REVERSE, ON 4" NOML. CHANNEL @ 16" O.C.
- PS - ONE LAYER 1/2" X 4" GWB ONE SIDE ON 4" NOML. CHANNEL @ 16" O.C. FLURRED TO 8" REINF. MASONRY
- PD - TWO LAYERS 1/2" X 4" GWB BOTH SIDES ON 4" NOML. CHANNEL @ 16" O.C. -STAGGER AND FINE TAPE ALL JOINTS.
- PE - ONE LAYER 1/2" X 4" GWB ONE SIDE ON 7/8" SETUP @ 16" O.C. FLURRED TO 8" REINF. MASONRY

LEGEND

- NEW 8" MASONRY WALL WITH STUCCO EXTERIOR FACING
- EXISTING MASONRY WALL
- NEW INTERIOR PARTITION
- NEW INTERIOR PARTITION-2 HOUR FIRE RATING
- EXISTING PARTITION TO REMAIN
- EMERGENCY SHOWER LOCATION

1 MEZZANINE PLAN
A102 1/8"=1'-0"

MEZZANINE

WALTER CHATHAM, ARCHITECT 390 BROADWAY #1001 212.625.2332 3030 YORK, NY 10018 376.866.2877		
INCLONE SYSTEMS-BROOKLYN 510 PARKSIDE AVE 710 PARKSIDE AND 316 CLARKSON AVE. BROOKLYN, N.Y.		
REV #	DATE	DATE REVISIONS & BY



A102